

MEPNN Supplier Scouting Opportunity Synopsis

Section 1: General Information

Scouting Number	2025-263
Item to be Scouted	Round Body Motor and Drive Board
Days to be scouted	21
Response Due By	09/03/2025
Description	1) DC Motor; Round Body; 12V; 80W; 4100 RPM; and 2) Motor Drive Boards; PMDC; PWM; 2000W; DC 9-55V; 40A

Section 2: Technical Information

Type of supplier being sought	Manufacturer
Reason	Re-shore
Describe the manufacturing processes (elaborate to provide as much detail as possible)	Includes but is not limited to rotor assembly, stator assembly. (mechanical assembly) for motor. Etching, drilling, plating, automated placement, and soldering (electronic/electrical assembly)
Provide dimensions / size / tolerances / performance specifications for the item	1) DC Motor; Round Body; 12V; 80W; 4100 RPM; and [SEE Drawing for exact diminsions] 2) Motor Drive Boards; PMDC; PWM; 2000W; DC 9-55V; 40A [SEE Drawing for exact diminsions]
List required materials needed to make the product, including materials of product components	Stainless Steel (pin), copper wire, resin, silicon sheets, magnets, brushes, shaft, bearings and varied electronic components depending on implementation
Are there applicable certification requirements?	No
Are there applicable regulations?	No
Are there any other standards, requirements, etc.?	No
Additional Technical Comments	

Section 4: Business Information

Estimated potential business volume	6700/yr per item. Will increase.
Estimated target price / unit cost information (if unavailable explain)	1) DC Motor: Current \$14 (Asia), future tbd 2) Motor Drive Board: \$3.60 (Asia), future tbd
When is it needed by?	ASAP
Describe packaging requirements	Best available. Delivered undamaged. Specifics discussed in negotiation.
Where will this item be shipped?	Atlanta GA

Additional Comments

Is there other information you would like to include?	
---	--

一 般 公 差				
尺寸範圍	0	5	17	65
	4	16	64	251
				以上
外 徑	+0	+0	+0	+0
	-0.10	-0.15	-0.20	-0.35
內 徑	+0	+0.10	+0.15	+0.20
	-0	-0	-0	-0
長 度	±0.10	±0.15	±0.40	±0.60
				±0.80

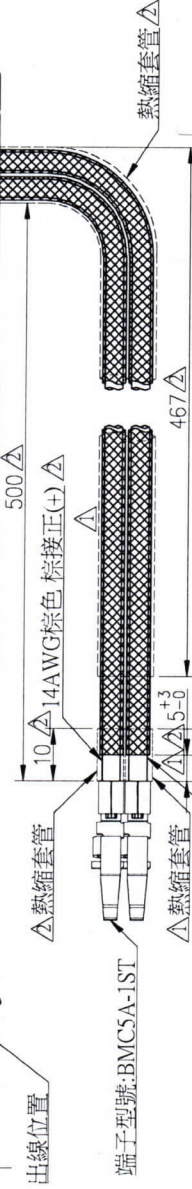
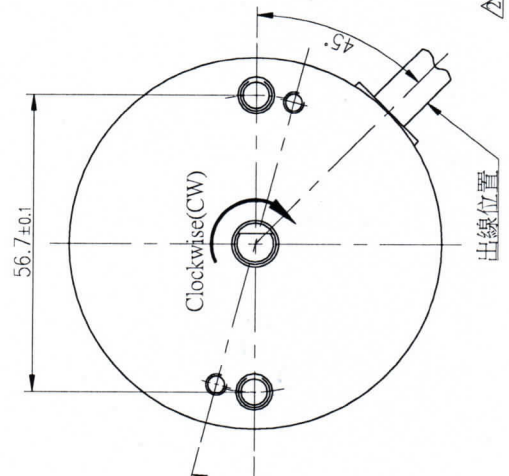
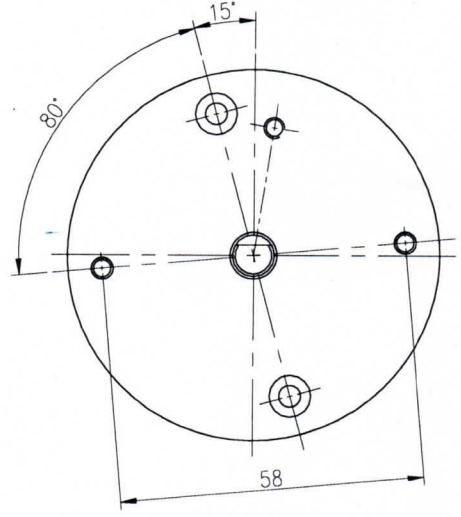
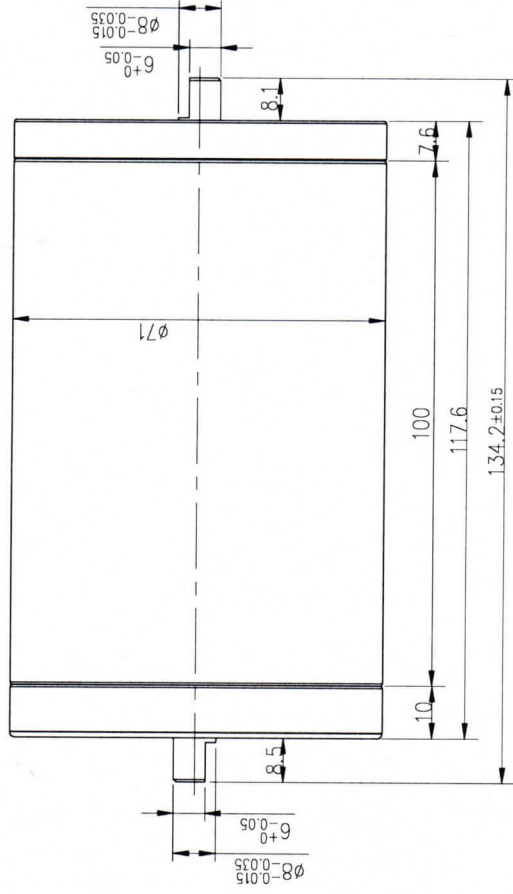

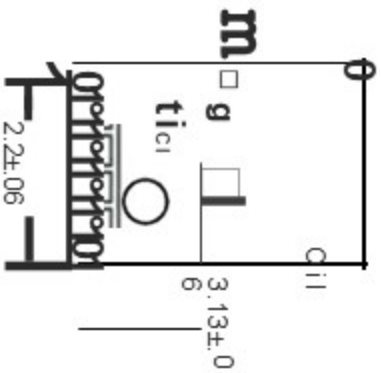
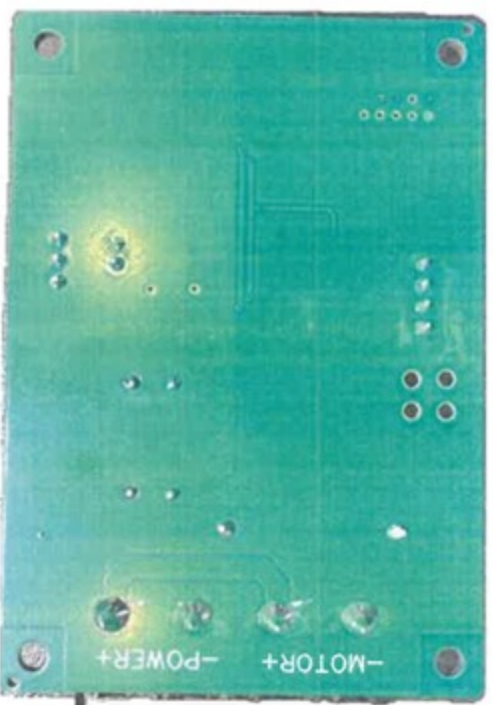
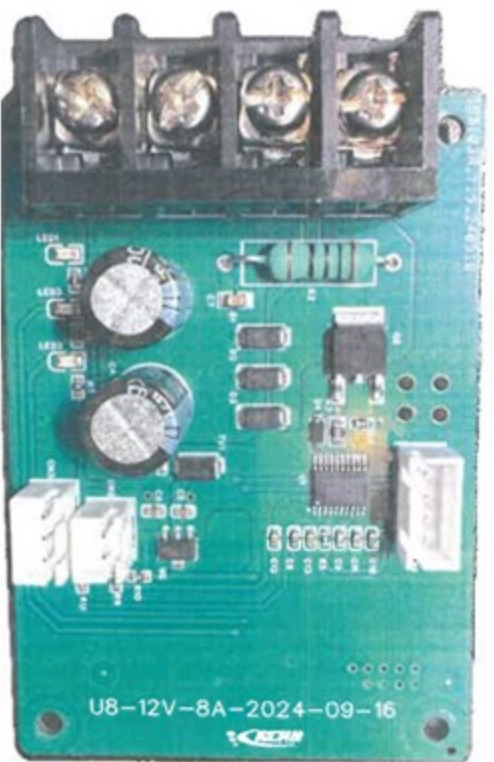

□CT1

PROJECT NAME AND COMMENTS		UNIT: 1/8" = 1" (25.4mm)		UNIT OF MEASURE: INCHES		PROJECT Common	
DRAWN		NAME		DATE		PART Motor Drive Board MDC	
CHECK							
COLOR							
MATERIAL		N/A				101283-QC	
FINISH		N/A				B	
						101283-QC	
						B	
						101283-QC	
						B	
						101283-QC	
						B	
						101283-QC	
						B	
						101283-QC	
						B	
						101283-QC	
						B	
						101283-QC	
						B	
						101283-QC	
						B	
						101283-QC	
						B	
						101283-QC	
						B	
						101283-QC	
						B	
						101283-QC	
						B	
						101283-QC	
						B	
						101283-QC	
						B	
						101283-QC	
						B	
						101283-QC	
						B	
						101283-QC	
						B	
						101283-QC	
						B	
						101283-QC	
						B	
						101283-QC	
						B	
						101283-QC	
						B	
						101283-QC	
						B	
						101283-QC	
						B	
						101283-QC	
						B	
						101283-QC	
						B	
						101283-QC	
						B	
						101283-QC	
						B	
						101283-QC	
						B	
						101283-QC	
						B	
						101283-QC	
						B	
						101283-QC	
						B	
						101283-QC	
						B	
						101283-QC	
						B	
						101283-QC	
						B	
						101283-QC	
						B	
						101283-QC	
						B	
						101283-QC	
						B	
						101283-QC	
						B	
						101283-QC	
						B	
						101283-QC	
						B	
						101283-QC	
						B	
						101283-QC	
						B	
						101283-QC	
						B	
						101283-QC	
						B	
						101283-QC	
						B	
						101283-QC	
						B	
						101283-QC	
						B	
						101283-QC	
						B	
						101283-QC	
						B	
						101283-QC	
						B	
						101283-QC	
						B	
						101283-QC	
						B	
						101283-QC	
						B	
						101283-QC	
						B	
						101283-QC	
						B	
						101283-QC	
						B	
						101283-QC	
						B	
						101283-QC	
						B	
						101283-QC	
						B	
						101283-QC	
						B	
						101283-QC	
						B	
						101283-QC	
						B	
						101283-QC	
						B	
						101283-QC	