

MEPNN Supplier Scouting Opportunity Synopsis

Section 1: General Information

Scouting Number	2025-169
Item to be Scouted	Custom Plastic Components
Days to be scouted	30
Response Due By	06/13/2025
Description	Missouri-based supplier needed to manufacture two custom plastic components: a tray and a handle. Each will be produced in green (Pantone 349c) and one additional, cost-effective color. The supplier must be able to

Section 2: Technical Information

Type of supplier being sought	Manufacturer
Reason	2nd Supplier
Describe the manufacturing processes (elaborate to provide as much detail as possible)	Client did not specify method, but parts are typically made using plastic molding or thermoforming. Open to any process that meets cost and volume goals.
Provide dimensions / size / tolerances / performance specifications for the item	Dimensions are provided in the attached reference drawings. Supplier should still be able to work with the client to confirm final specifications.
List required materials needed to make the product, including materials of product components	Plastic suitable for molding or thermoforming. Open to material suggestions based on durability and cost.
Are there applicable certification requirements?	No
Are there applicable regulations?	No
Are there any other standards, requirements, etc.?	No
Additional Technical Comments	Color specifications include Pantone 349c green and one secondary low-cost color option. Suppliers should include color matching capabilities if possible.

Section 4: Business Information

Estimated potential business volume	100 to 1,500 units per part, per color
Estimated target price / unit cost information (if unavailable explain)	Client is seeking price quotes for 100, 200, 500, and 1,500 units. Price sensitivity noted; cost-effective options preferred.
When is it needed by?	As soon as possible; no hard deadline provided. Client is actively requesting quotes.
Describe packaging requirements	Standard, cost-effective packaging suitable for part protection during shipment
Where will this item be shipped?	Neosho, MO 64850

Additional Comments

Is there other information you would like to include?	Client is open to supplier suggestions and values local relationships. Final specs and materials to be confirmed in discussion with supplier.
---	---

Green color is – Pantone 349c or Anything like below.



1. HANDLE: in Green and another color whatever is the cheapest option is, for color? QTY's are 100, 200 500, and 1,500 - for both colors

ITEM NO.	PART NUMBER	DESCRIPTION	Length	Material	StockSize	WE
1	1681-2503001-CTH	CRATE TOP HANDLE	4.500	BBIQ	N/A	0.

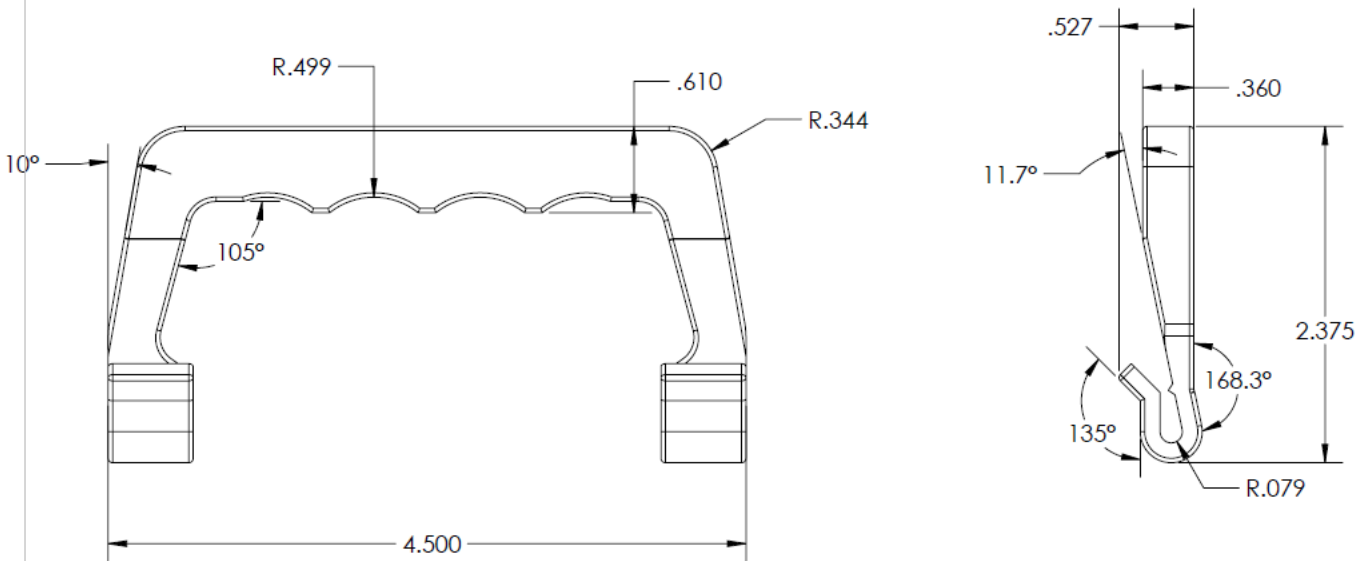

THIS DRAWING AND THE INFORMATION HEREIN ARE THE PROPERTY OF K & S WIRE PRODUCTS, INC. AND MAY NOT BE USED FOR ANY PURPOSE WHATSOEVER EXCEPT WITH CONSENT FROM K & S WIRE PRODUCTS, INC.

WIRE PRODUCTS
300 NELSON AVE.
NEOSHO, MO 64850
417-451-2323

PART#: 1681-2503001-CTH
DESCRIPTION: CRATE TOP HANDLE

CUSTOMER: 1681	FINISH: Raw	WEIGHT: 0.368	DATE: 3/1
DRAWN: LJB	APPROVED BY/ DATE:	PAGE: 1 OF 1	PAPER SIZE: A

DO THIS TO THE LINE ANGLE

1681-2503001-KS SHOP DRAWINGS REV.Q01

2. Tray: in Green and another color whatever is the cheapest option is, for color?
QTY's are 100, 200 500, and 1,500 - for both colors

ITEM NO.	PART NUMBER	DESCRIPTION	Length	Material	StockSize	WEIGHT	QTY.
1	1681-2503001-CTRAY	CAGE TRAY	36.102	ABS	.08	2.607	1

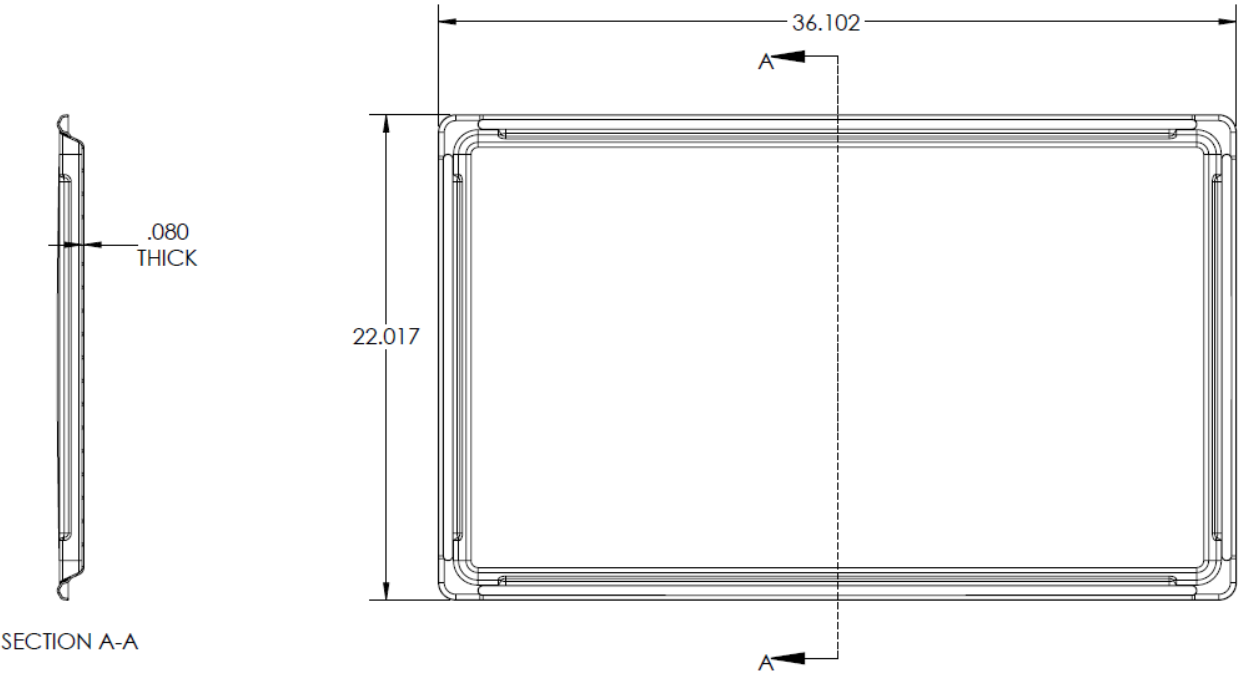

THIS DRAWING AND THE INFORMATION HERE IN ARE **CONFIDENTIAL**. THEY ARE THE PROPERTY OF **K & S WIRE PRODUCTS, INC.** AND MAY NOT BE USED FOR ANY PURPOSE WHATSOEVER EXCEPT WITH CONSENT FROM **K & S WIRE PRODUCTS, INC.**

K & S
WIRE PRODUCTS
300 NELSON AVE.
NEOSHO, MO 64850
417-451-2323

PART#: 1681-2503001-CTRAY			DO NOT SCALE THIS DRAWING	
DESCRIPTION: CAGE TRAY			TOLERANCE, UNLESS OTHERWISE SPECIFIED LINEAR - $\pm .030$ ANGULAR - $\pm .1^\circ$	
CUSTOMER: 1681	FINISH: Raw	WEIGHT: 2.607	DATE: 3/13/2025	
DRAWN: LJB	APPROVED BY/ DATE:	PAGE: 1 OF 1	PAPER SIZE: A	REV. Q01